

*Northwest Newsletter*  
*Zone Meet Edition*

STUDEBAKER DRIVERS CLUB  
PACIFIC CAN-AM ZONE MEET  
GRAND RONDE, OREGON

SEPTEMBER 9 - 11

2022



HOSTED BY THE NORTHWEST CHAPTER



**Welcome to The  
Studebaker Drivers Club 2022 Pacific Can-Am Zone Meet**

Hosted by the Northwest Chapter at Spirit Mountain Casino  
Al Johnston, NW Chapter President

As the president of the Northwest Chapter of the Studebaker Drivers Club it is a great honor to welcome and invite you to attend the Pacific Can – Am Zone Meet 2022. There is a pent-up pandemic induced desire to get out and drive those Studebakers and enjoy some of the best scenery in the world here in the Pacific Northwest.

We are looking forward to one of the best zone meets possible. We have chosen a venue that you will find offers many advantages. You will drive through some of the best vineyards, nut tree orchards, and scenery to arrive. You will stay at the Largest American Indian Tribal facility that is a great jump off point to the Pacific Ocean beaches, Outlet Mall Shopping, a dozen wine tasting venues all within a 32 miles radius, many golfing venues, and some of the largest airplane museums in the nation.

We have arranged a good price on rooms and will have a great Friday night gathering and a special banquet with a guest Speaker Mr. Ed Reynolds of Studebaker fame. What more could you ask for? **Oh yes!!!! there will be Studebakers!!!!** Since this is a Can-Am meet and the border is open we look forward to seeing our Canadian friends join us. I would imagine that you, like myself, are eager to re-unite with some of our Friends from around the Northwest. We might even be seeing others from beyond the Northwest join us. You will need to make your plans and register soon as we have high hopes of having a great turn out for this particular event. We have a great group ready to welcome you and make your Can-Am Meet the best ever. Register now, shine up those Studes and plan on joining us.

**Studebaker was affiliated with many different brands (automobile and others) throughout its history.**

**All are welcome at the Pacific Can-Am Zone Meet.**

Erskine	Pierce-Arrow	Gravely
Rockne	Packard	Onan
Everitt-Metzger-Flanders	Avanti	STP
Tincher	South Bend	McCullough
Garford	Clarke	Paxton

Here’s what’s inside this booklet ....

Welcome . . . . . 2

How to get there! . . Maps, Driving Directions . . . . . 3, 4

Headquarters Hotel . . . . . 5

RV Parking, Swap Meet, Registration, Car Wash . . . . . 6

Friday Welcome Social, Saturday Banquet . . . . . 7

Casino Map . . . . . 8

Schedule of Events . . . . . 9

People’s Choice Judging and Categories . . . . . 10

Things to do . . . . . 11

Rodger Eddy Memorial . . . . . 12

Pacific Can-Am Zone Chapter Contacts . . . . . 14-15

Oregon Coast Scenic Railroad Excursion . . . . . 16

Advertiser’s Index . . . . . 18

Zone Meet Registration Form . . . . . 19



## YOUR 2022 PACIFIC CAN-AM ZONE MEET ORGANIZING GROUP

**Jerry Blount**

**Paul Work**

**Al Johnston**

**Jennifer Arnold**

**Bob Williams**

**Randy Lorence**

**Dave Muck**

**Chuck Tubens**

**Tom Hart**

**Dana Scott**

### DRIVING DIRECTIONS FROM I-5 SOUTHBOUND OR NORTHBOUND TO SPIRIT MOUNTAIN CASINO, ABOUT 35 MILES

TAKE EXIT 253 HWY 22

TURN WEST TOWARDS SALEM. IF YOU ARE EXITING FROM THE SOUTH, TURN LEFT. IF YOU ARE EXITING FROM THE NORTH, TURN RIGHT.

Go about two miles and follow the sign to Hwy 22 right turn OR-99E BUSINESS exit toward OR-22 W/Willamette Univ./City Center  
0.2 mi



Turn left onto OR-22 W/OR-99E BUSINESS N/Bellevue St SE  
1.2 mi



Turn right onto the OR-22 W ramp to Marion St. Br  
0.1 mi



Continue onto OR-22 W/Marion St Bridge  
0.2 mi



Use the left 2 lanes to turn slightly left to stay on OR-22 W



Take the ramp to Oregon Coast



Merge onto OR-18 W/OR-22 W  
25.6 mi



Take the exit toward Spirit Mtn Casino

Turn right to underpass loop  $\frac{1}{2}$  Mile West of Hebo Rd. (Hwy 22)



### GPS GUIDE

If you are using a GPS (Global Positioning System) to get you to the Spirit Mountain area, try entering the address, 27100 SW Salmon River Highway, Grand Ronde, OR. If that doesn't give you the results you want, try 27100 Highway 18, or enter the name, Spirit Mountain Casino.

The Latitude / Longitude Coordinates are 45.060007, -123.582178

### HELPFUL HINT:

If you start relying on your GPS to guide you before you reach Interstate 5 Exit 253, you risk being routed over some narrow rural roads and/or congested city streets. It will probably get you there but we recommend that you stay on I-5 until you get near Exit 253 before engaging your GPS.



DRIVING ROUTE THROUGH SALEM FROM INTERSTATE 5 TO HWY 22. START AT THE LOWER RIGHT CORNER OF THIS MAP.

FROM HERE, DRIVE 26 MILES ON HIGHWAY 22, THEN HIGHWAY 18 TO SPIRIT MOUNTAIN.

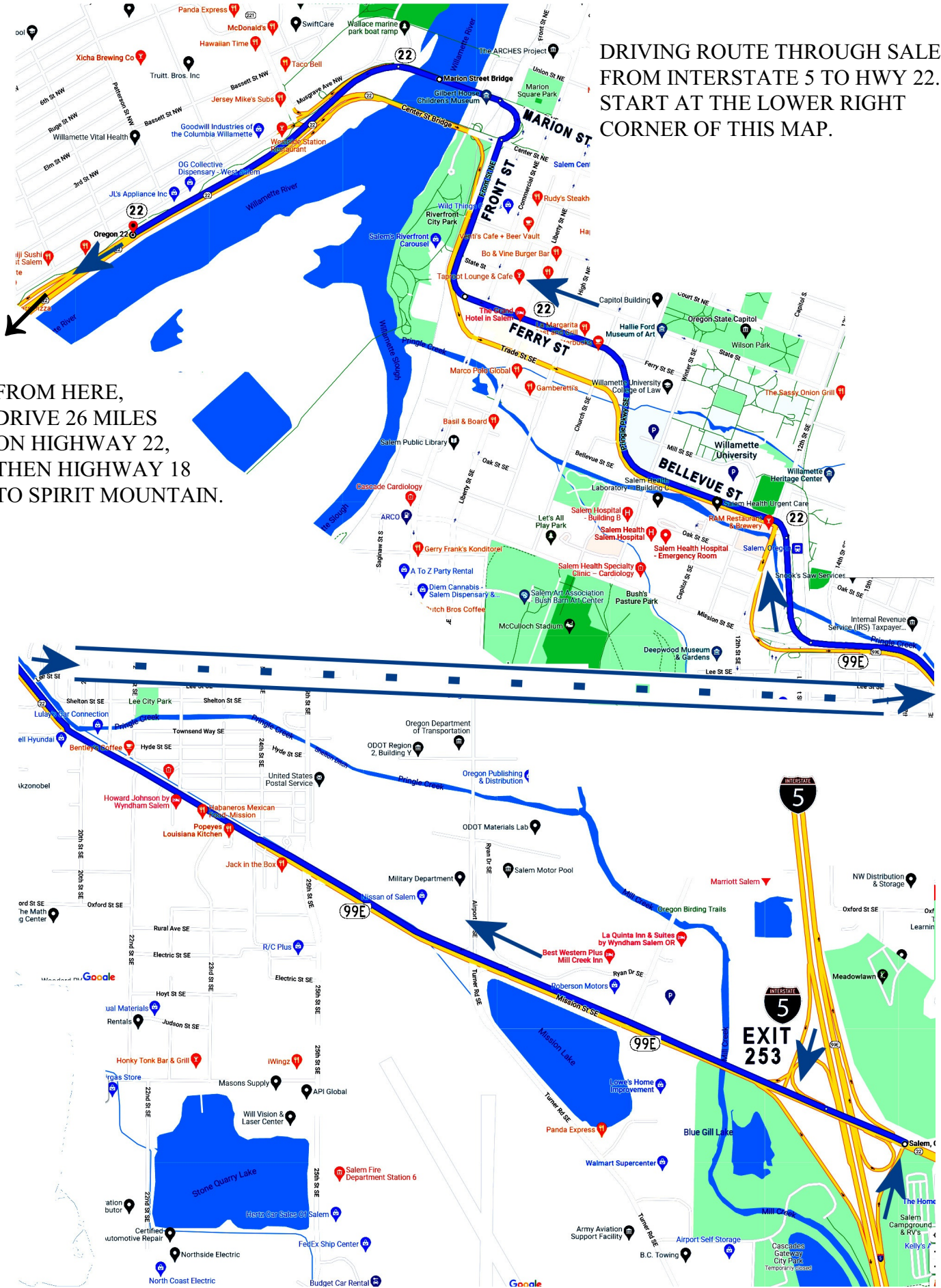



**Zone Meet Headquarters . . . Spirit Mountain Lodge**

Location: 27100 Salmon River Hwy, Grand Ronde, OR 97347

Hotel Reservations: \$149 per room, plus 10% tax. (for a standard room)

- By Phone: 1-800-760-7977 & give the Group ID 3019 (Studebaker of Oregon).
- Online: Go to Spirit Mountain Casino’s website and click “Group Sign In” at top, enter Group Code: 3019.  
(Please make sure to use the Group ID above when making your reservation so that the club gets credit for your reservation and meets our minimum reservation quota.)

Located only 60 miles from Portland, Spirit Mountain Lodge has a variety of room types, all of which have a mini-fridge, Keurig coffeemaker, cable TV, iron, and ironing board. The Standard rooms have either two queens or one king bed. There is 24-hour front desk service and free parking and free Wi Fi.

The Spirit Mountain Lodge also has a number of dining options onsite: Amore, which serves Italian food in a casual, relaxed atmosphere; Summit View Lounge, which has a hopping lounge and sleek dining area; Mountain View Sports Bar; and Rock Creek Court Deli, serving food, mixed drinks, and beer from the heart of the casino. Plus, there is a cafe serving coffee and tea onsite.

And of course – let’s not forget that for entertainment (between checking out all the Studebakers at the event) there is a casino onsite, which is the largest non-smoking casino in the state. The casino has table games, such as exhilarating blackjack, tempting roulette, and the laid-back game of Pai Gow, as well as slot machines and Keno. Plus, if you love sports, there is online sports betting through an app that can be downloaded from Spirit Mountain’s website and then enjoyed on the big screen TVs at the lodge’s sports bar.



1/2 MILE WEST OF HEBO RD (22)

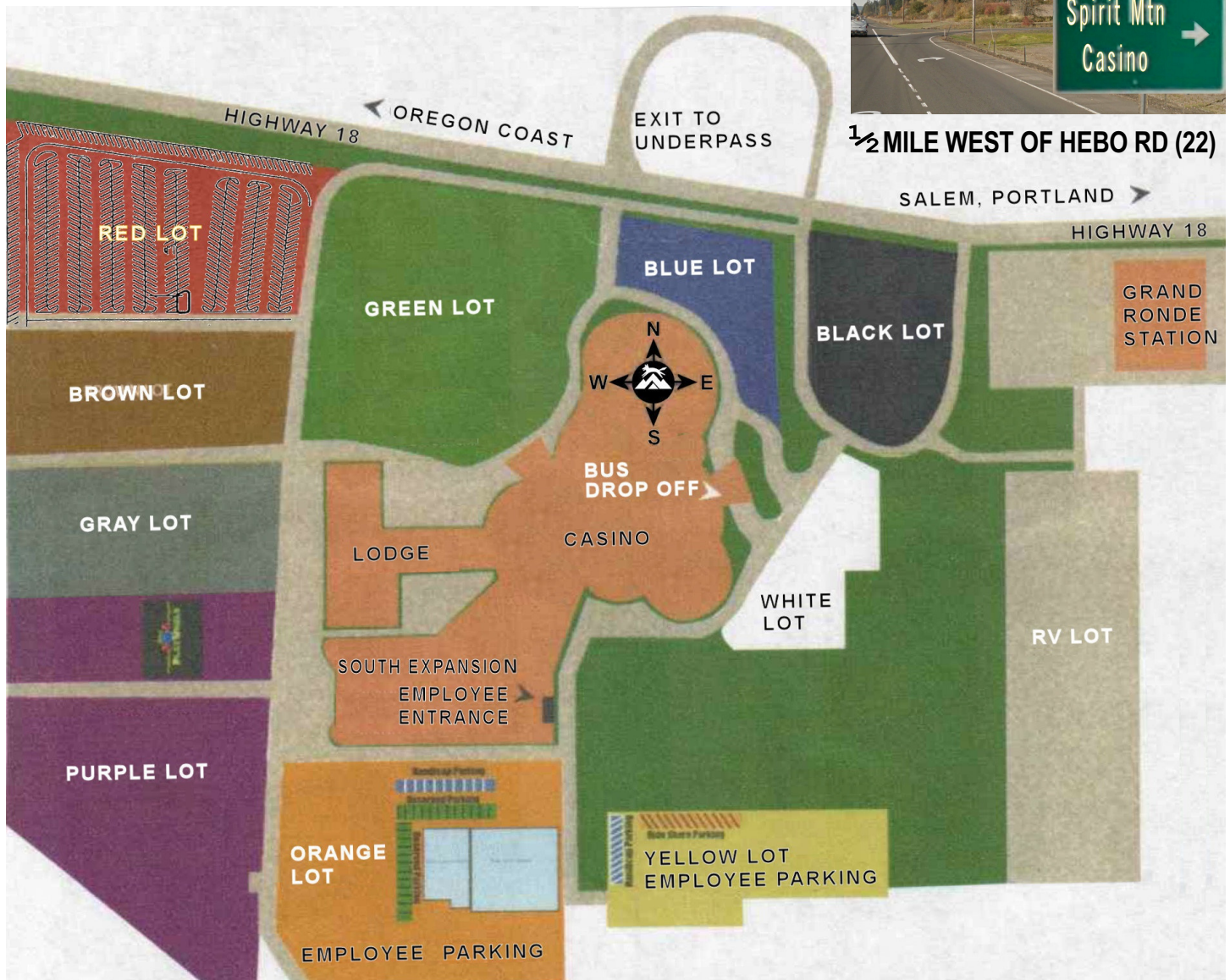

GRAND RONDE STATION

SALEM, PORTLAND

HIGHWAY 18

HIGHWAY 18 OREGON COAST

EXIT TO UNDERPASS



BUS DROP OFF

LODGE CASINO SOUTH EXPANSION EMPLOYEE ENTRANCE

EMPLOYEE PARKING

YELLOW LOT EMPLOYEE PARKING

RV LOT



**RV PARKING**

There is an RV parking area at Spirit Mountain Casino. It is on the East side of the complex, behind the Service Station.

As you are taking the entrance loop, a sign will direct you to the left to access the RV parking area.

This is a “dry camp”. It is a large paved area, but with no hook-ups for electricity, water, or sewer. There are no on-site bathrooms or showers - your RV must be self-contained.

The good news is that it is free. They do want you to register on arrival, however.

The area is walking distance to the lodge. Our car show/swap meet area is on the West side, so a little more walking to reach that.

If you don’t want to dry camp, the “Wandering

Spirit” RV park is just 2 miles West of the Casino, on Hwy 18. It is a clean, nicely landscaped park with both back in and pull through sites. They have over 100 spaces with full hook-ups and 24 hour restrooms and showers. As of this writing, rates are \$50.00 with a 10% discount for Good Sam or AAA members.

They do run a shuttle bus to Spirit Mountain Casino. Reservations at 503-879-5700.

Our Sunday event is the ride on the Oregon Coast Scenic Railroad, leaving Garibaldi, OR.

If you elect to spend some additional time on the Oregon Coast, there are many RV parks along Hwy 101. Search <campgrounds.rvlife.com> for access to these parks. Space availability should be good since we are after the Labor Day weekend.

**SWAP MEET**

The Swap Meet will be on the same lot as our Car Show, allowing easy access and plenty of foot traffic.

The lot is known as the Red Lot (see the diagram on Page 5) and the swap spaces will be on the south side, next to a grassy divider. There are 18 spaces, and they are full 10’ X 20’ with a little bonus space in the grass.

If pre-registration indicates the need for more spaces, we can also use the west side of the Red lot. 12 additional spaces are available

The Swap Meet will be open:  
Friday Sept. 9th: 12:00PM - 5:00PM  
Saturday Sept. 10th: 7:00AM - 5:00PM

**ZONE MEET REGISTRATION TABLE . . . HOSPITALITY**

On Friday, September 9th Registration will be open from 12:00 Noon until 7:00 PM.

The registration table will be located in the Event Center (See No. 20 on the Casino Map on Page 8).

On Saturday, September 10th, Registration, will be open from 7:00 AM until 10:00 AM. Hospitality and a Zone Meet Information Booth will be open from 9:00 AM until 11:00 AM.

Both will be located in a tent in the Red parking lot.

**CAR WASH**

Hoses and water will be available near the car show area.

Please supply your own cleaners, brushes, sponges and wiping cloths.



**FRIDAY NIGHT WELCOME SOCIAL**

7:00 to 10pm in the Molalla Room, (See 19 on the Casino Map on Page 8) Appetizers and Cash Bar. Meet and Greet old and new SDC friends.

For dinner, we recommend that you visit one of the four restaurants in the Casino area and order a flavorful meal that suits your taste.

**SATURDAY AWARDS DINNER BANQUET**

The Banquet features a "Tour Of Italy" Buffet Dinner and Cash Bar. The program includes Car Show Judging Awards, Keynote Speaker

Ed Reynolds, Auction, Raffle and a 50/50 prize winner. The doors to the Kalapuya room 18 will open at 6:00pm. Dinner will start at 7:00pm.



**Specializing in 56J Parts**

Brent Hagen  
 6220 S.E. 55th Ave  
 Portland, OR 97206-6800  
 Cell: 971-219-9687  
 E-mail: ghawk352@effectnet.com  
 www.StudebakerVendors.com/hagen





**DAVID R. JOTHEN**  
 PRODUCER  
**503-860-8041**  
 105 NW 2ND ST.  
 GRESHAM, OR 97030  
 PDXCLASSICCARINSURANCE@GMAIL.COM  
 WWW.THEINSURANCEGARAGE.COM

 **GOLDEN HAWK**  
**FIREARMS TRAINING**  
 Randy Lorence NRA-Certified Instructor FFL-SOT  
 2809 SE 122nd Ave  
 Portland, OR 97236  
 rjlorence@msn.com  
 (503) 348-5666



# CASINO MAP

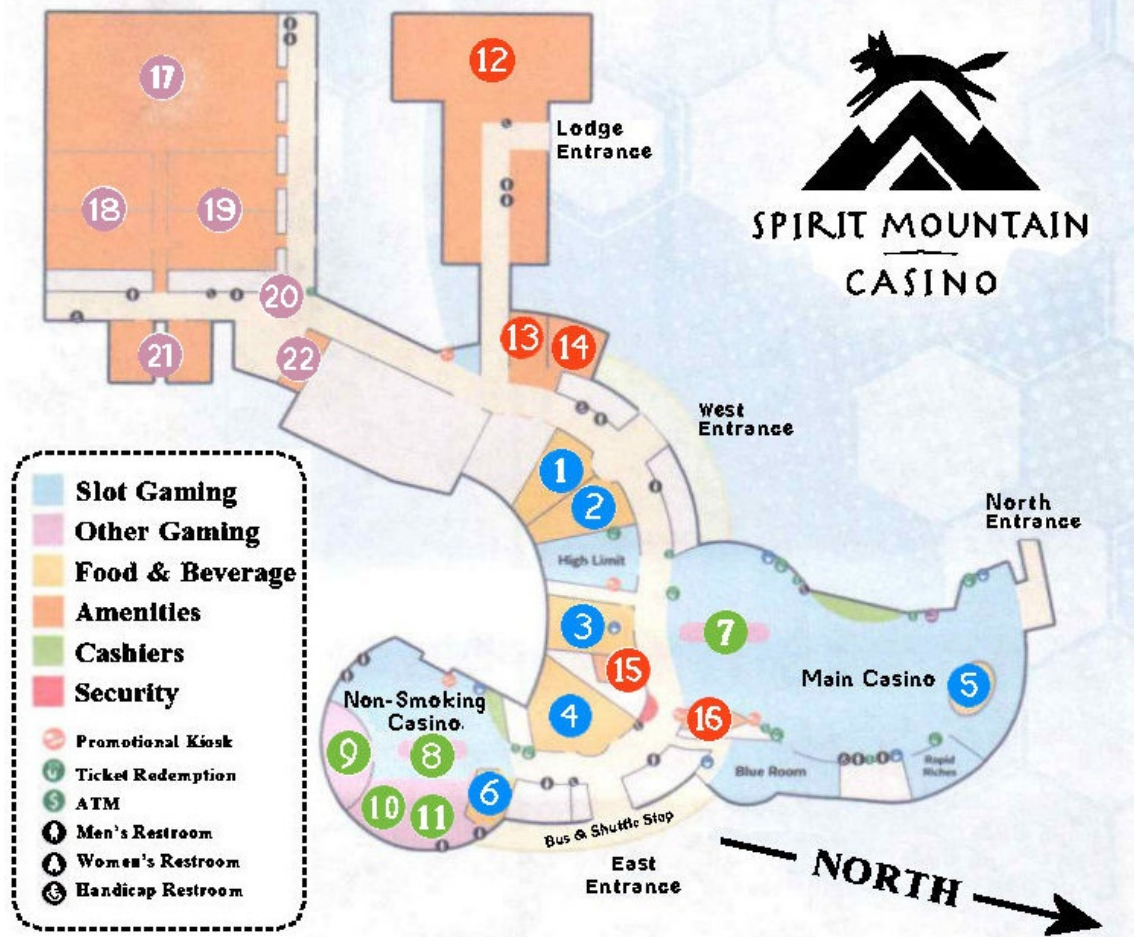

## Food & Beverage

- 1 Legends Restaurant
- 2 Summit View Lounge
- 3 Rock Creek Court Deli
- 4 Mountain View Sports Bar
- 5 North Bar
- 6 Stadium Bar

## Amenities

- 12 Lodge
- 13 SIPS Coffee-Tea-Wine
- 14 Gift Shop
- 15 VIP Services
- 16 Coyote Club

## Gaming

- 7 Main Table Games
- 8 Non-Smoking Table Games
- 9 Video Poker
- 10 Keno
- 11 Sportsbook

## Concerts & Events

- 17 Event Center
- 18 Kalapuya A & B
- 19 Molalla A & B
- 20 Box Office
- 21 Umpqua A & B
- 22 Chasta A & B





## 2022 Pacific Can-Am Zone Meet

## SCHEDULE OF EVENTS

**Friday, September 9, 2022**

Event	Time
Swap Meet Open	12:00pm-5:00pm
Car Wash Open	12:00pm-6:00pm
Registration Open (located at #20 on the map). Raffle tickets for sale.	12:00pm-7:00pm
Welcome Social– Appetizers and Cash Bar (Dinner on your own) Event held in Spirit Mountain room, Molalla A&B (located at #19 on the map)	7:00pm-10:00pm

**Saturday, September 10, 2022 International Drive Your Studebaker Day**

Event	Time
Registration Open (located at #20 on the map). Raffle tickets for sale.	7:00am-10:00am
Car Wash Open	7:00am-10:00am
Swap Meet Open	7:00am-5:00pm
All car show vehicles start moving towards line for car photo. (Get photo before entering car show!)	9:00am-11:00am
After getting car photo, proceed to red parking lot for car show positioning.	9:00am-11:00am
Zone Meet Information Booth/Hospitality Tent Open (tent in red parking lot). Raffle tickets for sale. Water available.	9:00am-11:00am
Car show vehicle display open to public viewing and People's Choice Judging	10:00am-2:00pm
Free Time	2:00pm-7:00pm
Awards Dinner Banquet. Buffet dinner. Cash Bar. Announcements, Car Show Awards, Key Note Speaker, Auction, Raffle, 50/50 winner. Doors to banquet room open at 6:00pm. Dinner is served at 7:00pm. Event held in Spirit Mountain room, Kalapuya B (located at #18 on the map)	6:00pm-10:30pm

**Sunday, September 11, 2022**

Event	Time
Drivers' Meeting for Tour to Train Ride in Garibaldi, Oregon	9:30am
Depart Spirit Mountain Casino to Train Ride in Garibaldi, Oregon	9:45am SHARP
Driving Caravan from Spirit Mountain Casino to Train Ride in Garibaldi, Oregon	9:45am-11:30am
Train Ride. Departing Garibaldi to Rockaway Beach (30-minute ride one-way)	12:00pm
Train Ride, Return from Rockaway Beach to Garibaldi (30-minute ride one-way). (Passenger must inform the station attendant at the time of departure their choice of return time: 1:00, 3:00, or 5:00pm.)	1:00, 3:00, or 5:00pm, passenger's choice



## People's Choice Judging

**Why People's Choice?** The Northwest Chapter has decided, based on our prior hosting experiences, that People's Choice Judging is our preferred way to judge the vehicles at the shows that we host. This is because the Northwest Chapter found in its experience that formal judging to establish trophy winners at a car show can be difficult for a number of reasons. In particular, the club found that it was difficult to find enough qualified judges and then it seemed unfair to require those judges to spend the entire car show busy judging, with no time to relax and enjoy the cars. Plus, formal judging requires the car owners to be with their car when it is judged, which also restricts the time of the car owners at the show. The club also noticed that fewer people were entering their cars for judging and more car show attendees wanted their vehicles to be for display only.

As a result of all the above considerations and because we want the zone meet to be enjoyable for all participants, we are doing "People's Choice Judging," which was a big hit at the last zone meet we hosted in 2015.

**How does it work?** Under People's Choice Judging, every registered zone meet participant will receive a ballot to select their favorite car in each category. (For example, if you registered a family of 2, you will receive 2 voting ballots.) All of the cars on the show field will be candidates for judging. The ballots will be tallied after the car show and awards for each category (listed below) will be presented at the awards dinner banquet on Saturday night. (The awards banquet is a ticketed event for which you need to pay an entry fee in advance – at the time of registration, which includes dinner.) Our hope is that this type of judging will make the car show much more enjoyable for everyone!

**Car Show Time & Location.** The car show is on Saturday, September 11, 2022 from 10:00 to 2:00pm. However, all car show participants need to start lining their cars up for a photo of their car **by 9:00am**. Photos will be taken of the cars and drivers as the cars are entering the car show area. After having the car's photo taken, the cars will then proceed to the car show area, where one of our volunteers will direct the cars and trucks where to park based on their category. The car show will take place in the Red parking lot located behind the Spirit Mountain Casino. There will be signs and volunteers indicating where to go once in the area. Have your car parked by no later than 11:00am for People's Choice Judging.

**2022 Pacific Can-Am Zone Meet People's Choice Judging Categories.** Please note: People's Choice Judging is not formal 400-point judging. Instead, the attendees will mark their ballots with the identifying number of the car they like best in each category. The voters should use whatever judging standards they think are appropriate.

### Ballot Categories.

First, second, and third place awards will be given based on the highest number of ballot votes received from the people in the following categories:

1. Pre-war, 1904-1946;
2. Post-war, All non- C&K Sedans & Wagons, 1947-1958;
3. C&K Coupes & Hardtops, 1953-1961;
4. Lark-type, 1959-1966;
5. GT Hawks, 1962-1964;
6. Avanti – Studebaker;
7. Avanti - All others;
8. Trucks, 1902-1964;
9. Non-stock, Studebaker-powered; and
10. Non-stock, Not Studebaker-powered.

### Non-ballot Categories.

The Northwest Chapter will select the winners for the following awards:

1. Longest distance driven in a Studebaker, Canada;
2. Longest distance driven in a Studebaker, US; and
3. Hard Luck Trophy.
4. Best Of Show Award

### TROPHY SPONSORSHIPS

We are offering you an opportunity to sponsor the trophies, First, Second and Third Place, in one or more of the Judging Categories. Each category may be sponsored for a contribution of \$25.00. Your Sponsorship will be acknowledged during the Awards Presentations at the Banquet. If you would like to support the SDC Pacific Can-Am Zone and the Northwest Chapter with this generous gesture, please contact Jerry Blount at (503) 658-6914 or [studebakerceneteroforegon@comcast.net](mailto:studebakerceneteroforegon@comcast.net). Jerry can tell you what categories are available for sponsorship. Your contribution check should be payable to "Northwest Chapter, SDC" and mailed to Northwest Chapter Treasurer, John Berg. John's address is  
8015 SW 45th AVE  
PORTLAND OR 97219



THINGS TO DO

Wine Tasting Tour.

There is a wine tasting loop that starts traveling East from the hotel. On Hwy 22 you will find Chateau Bianca Winery, Benedetto Vineyards, Eola Hills Wine Cellars. Taking a short jaunt you can include Legacy Estate Vineyard on Oak Grove Rd. Finding your way to Hwy 221 your next stop will be Denison Cellars, Audeant Wines and Tastings. Going West on Hwy 153 and turning on Eola Hills Rd., you will find Varnum Vintners and Grochau Cellars. Set your GPS and let it guide you through some scenic route or return to Hwy 153 and find Coelho Winery. You can explore some of the area on your way back to Grand Ronde and find the Coleman Vinyard, J Wrigley Vineyards, Roshambo Artfarm Art + Science (might be closed) and Ransom Wine Company and Distillery tucked away in the hills on your way back to the motel.

Pacific City

Visit the ocean town of Pacific City 27 miles from the hotel. This peaceful little coastal town has a 200 foot sand dune to climb and a unique breakwater that offers surfers and anglers rich rewards. This is home to Cape Kiwanda and Haystack Rock. Pacific City's beach provides fishermen with the safest route out to sea. Using special shallow-draft boats called dories, they launch straight into the surf; on the way back in, they sound a loud horn and surf right back onto the beach. You can charter a day of fishing with one of these dories or grab a seat at the Pelican Pub and brewery and enjoy fine food and unique brews brewed on site and watch the beach from their "on the sand deck" or sheltered inside in a very nice restaurant.

Casino Tour

You will not have to travel far to enjoy Casino activity since your hotel is part of the Spirit Mountain Casino. Spirit Mountain is operated by the Confederated Tribes of Grand Ronde and according to their claims this is the largest of the 9 Indian Casinos in Oregon. There is also a Casino in Lincoln City called Chinook Winds. That Casino is 24 miles from the Meet hotel.

Golfing Opportunities

There are several Golf courses of note in the area and on the Oregon Coast. There are 14 golf courses within 30 miles of the host hotel. Several of these like the Neskowin Beach Golf Course and Westin Salishan Golf Links are located right on the beach. Salishan is modeled after Scottish Links.

Tillamook Creamery and Tillamook Smoker

One of the largest visitors attractions on the Oregon Coast is the Tillamook Creamery in Tillamook OR 45 Miles from the host hotel and on the way to the Train ride event on Sunday. The creamery has a self guided tour where you can see how the cream and cheese is made. There is a sampling area for the different kinds of cheese. There is a large gift store and place you can buy all of the cheeses. Of course you will not want to miss buying some of the best ice cream cones in the world. Just up the road is the Tillamook Smoker with great selections of smoked items that will be worth the stop as well.

Museums

Evergreen Air & Space Museum, located in McMinnville on Hwy. 18 is home of the one-of-a-kind Spruce Goose, plus many other aviation displays.

Tillamook Air Museum is located just off Hwy. 101, south of Tillamook. It is housed in one of the two World War 2 Blimp Hangars. It looks big from the highway, but walk inside, it looks bigger on the inside.

Shopping

Woodburn Outlet Mall, off of I-5 in Woodburn has easy access and many, many brand name stores. Depending on your route to the meet, might be too good to pass by and not take a look. From the Hotel you can travel 26 miles to the Lincoln City Outlet mall for a nice smaller mall with even an axe throwing area for entertainment.

Grand Ronde History

Chachalu Tribal Museum & Cultural Center- located in Grand Ronde presents the history of the Grand Ronde Tribe.

**NORTHWEST BATTERY SUPPLY**

3750 S.E. BELMONT, PORTLAND, OR 97214  
PHONE: (503)232-9002 FAX: (503)231-5733

**Ron's FRONT END & BRAKE SERVICE** Since 1984  
"All Work Guaranteed"

- 2 & 4 Wheel Align
- Custom Welding
- Steering Rack
- Axles
- Motorhome Repair
- Front Wheel Drive
- 4 Wheel Drive
- Domestic & Import
- ABS Repair
- AC Service

Ron Solomon • 503-775-8189 • Robert Porter  
5912 SE Foster Rd., Portland, OR 97206  
www.Ronsfrontendandbrakes.com



## THE NORTHWEST CHAPTER DEDICATES THIS SDC ZONE MEET IN HONOR OF ITS FOUNDER, RODGER DELMAR EDDY 1929-2022

A native Portlander and great-grandson of Oregon Trail pioneers, Rodger Delmar Eddy died on January 20, 2022 at the age of 92.

Firstborn son of Delmar and Suzanne Eddy, Rodger was born in Portland on December 22, 1929 during the Great Depression, grew up on 52nd and Oregon Street, and his family's first car was a brand-new light blue 1937 Studebaker chosen for its independent front suspension but lacking a radio and heater.

Then came Pearl Harbor and gas rationing through childhood, and another new car, a shiny green 12-cylinder Lincoln coupe in 1946 when he would have been attending what he called 'Grant High, the best high school in the U.S.', where he graduated in 1948. The old family Studebaker became Rodger's first car which he drove to his classes at Vanport College in Portland that was to become Portland State. He transferred to Eugene and graduated from the University of Oregon's Journalism school in 1952. It's hard to tell his life story without talking about cars.

Rodger met his beautiful wife Janet Christine Godey in 1957 at a Servitus Dance for singles in downtown Portland when he asked her to dance during the last half of the last dance. Janet had been talked into driving her roommate to the dance in her Nash Rambler and was reluctant to go, but for her it was love at first sight, and their song was "Save the Last Dance for Me." They were married in a New York City elopement in 1959 and had three daughters and a son, Cecily Eddy Spencer, Melanie Eddy Robinson, Angela Eddy Sandino, and Rodger Lee Eddy, 14 grandchildren and one great-grandson. Baby son of his son, Natthan 'Hawk' Eddy preceded him in death in 2018, the rest survive him.

His first journalism job as photographer, writer, sports editor and later advertising manager for the Gresham Outlook weekly newspaper began with his first assignment there to track down a two headed frog. Rodger was notorious for driving his futuristic 1936 gray purple Cord Phaeton with white top that he purchased in L.A. in 1951, and what he called 'my stubborn penchant for driving old cars' remained all his life.

As an investigative journalist, he wrote a complex piece on alleged fluoride poisoning of cattle



and flower bulb farms from Reynolds Metals in Troutdale, and a piece that caused a libel suit that the Outlook won and resulted in the law that liberalized free protected speech for newspapers. He went on to manage the Sandy Post and Parkrose Enterprise before launching his own publication, the North Willamette News in Aurora in 1964.

In the summer of 1968, Rodger was the instigator of a meeting of Studebaker owners at Silver Falls that developed into the Charter Meeting of the Studebaker Drivers Club, Northwest Chapter. He served as Chapter President in the early years and was an avid promoter of club activities for the next 54 years. In 1993, when the Northwest Chapter hosted the Studebaker Drivers Club International Meet, he organized and led a 10-day driving tour of the Oregon Trail from Independence Missouri to Portland. The tour participants, mostly driving Studebaker cars and trucks, numbered almost 50 in some segments along the route.

Baptized as an infant in the Episcopal Church, Rodger died peacefully surrounded by his family at home as they sang 'Swing Low, Sweet Chariot', a poetic full circle to his love for earthly chariots, demonstrating to all present how the final foe, death, is overcome by the goodness and grace of God and faith in Jesus Christ, which Rodger professed. Right after his soul's departure, three family members photographed the exquisitely beautiful sunset outside.

Rodger wore ties and pegged pants all the way through the 1970s, was an unswerving optimist, a genius at writing, formal, kind, funny, smart, hard-working, a true egalitarian, faithful to his wife, eccentric, patriotic, whole-hearted, talked to his children like they were grown-ups, adored jazz, he believed in life, in people, in parades, in free speech, in America.

Charitable Donations in his memory may be made to the Northwest Chapter of the Studebaker Driver's Club, which was founded by Rodger Eddy, at [sdc-nw.com](http://sdc-nw.com) or by contacting the club's treasurer, John Berg, at [john\\_b@transportwisdom.com](mailto:john_b@transportwisdom.com).

Rodger was buried with a Christian ceremony at the Aurora Community Cemetery next to his parents.



Pacific Can-Am 2022 Zone Meet T-Shirts

Order yours when you send your Registration Form.  
Available in S, M, L, & XL for \$18  
Available in 2XL or 3XL for \$20

If you wait to buy your shirt until you arrive at the Zone Meet, there's a risk that we won't have a shirt in your size.



Industrial **TIRE** Service

**COOPERTIRES** **TRELLEBORG**  
**Continental**  
**GENERAL TIRE** **MICHELIN**  
**UNIROYAL** **BFGoodrich**

SPECIALIZING IN  
 PASSENGER & LIGHT TRUCK  
 BRAKES & ALIGNMENT  
**(503) 256-1016**  
**FAX (503) 252-8625**  
**LARRY COLEMAN**  
 7331 N.E. KILLINGSWORTH  
 PORTLAND, OREGON 97218  
 www.industrialtire.com

C: (503) 740-3865  
 O: (503) 912-1207  
 haysuphegmail.com  
 37 SE Hogan Rd Gresham,  
 OR 97030

*Refinishing Touch Auto Body*  
 info@refinishingtouchauto.com

**Jeff Carlson**

Phone: 503.657.1845  
 Fax: 503.650.9093

16075 SE 106th Ave  
 Clackamas, OR 97015



PACIFIC CAN-AM ZONE CHAPTERS



**Vancouver Island**  
 Duncan, BC  
 Mark Hayden, /Editor  
 haydenmj @ shaw.ca



**Greater Seattle**  
 Sammamish, WA  
 Odd Justed  
 stude21 @ juno.com



**BC Coastal**  
 Coquitlam, BC  
 Mark Carson, Editor  
 markcarson007 @ hotmail.com

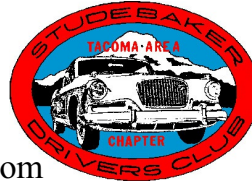

**Tacoma Area**  
 Spanaway, WA  
 Dennis Massie  
 d2massie@gmail.com



**BC Southern Interior**  
 North Vancouver, BC  
 Colleen Wiens  
 wcoll1 @ telus.net



**Central Washington**  
 Cle Elum, WA  
 Ruth Van Kommer  
 Ruthvk25 @ hotmail.com



**Edmonton**  
 Edmonton, AB T5X 2M3  
 Wayne Youngward, Editor  
 wsyong @ telus.net



**Inland Northwest**  
 Davenport, WA  
 Brian Curtis  
 briankcurtis22 @ yahoo.com



**Foothills**  
 Calgary, AB  
 Jack Gegory  
 jackgegory @ shaw.ca

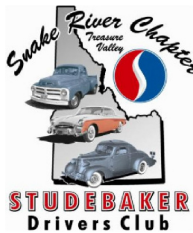

**Snake River**  
 Nampa, ID  
 Diane Mortensen  
 dsmort @ msn.com



**Whatcom County**  
 Bellingham, WA  
 Stephanie Bell, Editor  
 liv4today@comcast.net



**Shadow Of The Tetons**  
 Idaho Falls, ID  
 Bill & Heidi Bacon  
 shadowofthetetons @ msn.com

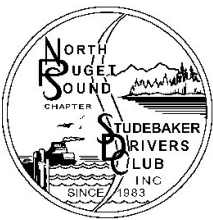

**North Puget Sound**  
 Lynnwood, WA  
 Pat Knappert, Editor  
 patcarol @ frontier.com



**Yellowstone**  
 Billings, MT  
 Jack Salvesson  
 pennngwen2017 @ gmail.com



PACIFIC CAN-AM ZONE CHAPTERS

Continued from Page 12



**Northwest**  
Portland, OR 97229-6235  
Jennifer Arnold, Editor  
jenniferrarnold @ yahoo.com

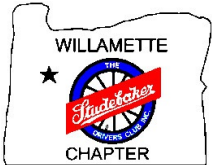

**Willamette**  
Corvallis, OR  
Jean Lasseter  
jlass @ dswebnet.com



**Studebakers Of Southern Oregon**  
Grants Pass, OR  
Craig Clark, Editor  
crgclk @ qnet.com



**Antique Studebaker Club,  
Pacific NW Chapter**  
Brian Curtis, Editor  
briankcurtis22 @ yahoo.com



**Club Avanti Northwest**  
Lynnwood, WA  
Lou Cote', President  
dynoloucote @ gmail.com

**Pacific Can-Am Zone Coordinator**  
Mark Hayden  
haydenmj @ shaw.ca

**Pacific Can-Am Zone  
National Director**  
Mark Carson  
markcarson @ hotmail.net



JERRY & CARI BLOUNT  
STUDEBAKER PARTS



13223 S.E. WIESE RD.  
DAMASCUS, OR 97089  
(503) 658-6914

studebakercenteroforegon@comcast.net



*Come Ride the TRAIN!!*



*Sunday, September 11, 2022*  
*As part of*  
*The Northwest Chapter of the Studebaker Driver's Club's*  
*Pacific Can-Am Zone Meet for 2022,*  
*we are pleased to offer a*  
*Tour and Train Ride on the Oregon Coast Scenic Railroad.*

DRIVING TOUR TO GARIBALDI, OR for a TRAIN RIDE - SEPTEMBER 11TH

We are going to take a train ride along the Oregon coast from Garibaldi, Oregon to Rockaway Beach, Oregon. Please note that the train is disabled persons accessible. We will all drive out to the train in Garibaldi together, caravan-style, from Spirit Mountain Casino.

There will be a driver's meeting in the parking lot by the car show area at 9:30am for all the drivers caravanning to the Garibaldi train. The group will depart at 9:45am sharp. **MAKE SURE YOU HAVE A FULL TANK OF FUEL.** The train station is about 75 miles from Spirit Mountain Casino. The one-way drive to Garibaldi from Spirit Mountain will take around 1 hour and 45 minutes.

When we arrive in Garibaldi (about 11:30am), we should have approximately 30 minutes before the train ride starts to stretch our legs. If you want, you can get something to eat across the street from the train station; there is a bakery and a Dairy Queen. (No food is offered on the train.) But, mind your time -- you need to be ready to ride the train by 12:00pm. The train station has restrooms (porta-potties). There is also plenty of secure parking available next to the train station.

The train will depart Garibaldi at 12:00pm. The train ride to Rockaway Beach lasts 30 minutes. From Rockaway Beach, you can choose to come back on the train at 1:00 pm or spend some extra time in Rockaway Beach and return to Garibaldi on either the 3:00pm or 5:00pm train. When the train ride is over it is your choice to return home, go back to the casino, or stay a few nights on the Oregon coast. We hope you enjoy the 2022 Pacific Can-Am Zone Meet! Looking forward to seeing you there -- the NW SDC Chapter.





We are committed to supplying the best transmissions and transmission parts with an emphasis on quality and value. If you're looking for great service and great prices without compromising quality and value, call us first.

**Transmission Exchange Co.**



Portland



503-284-0768  
800-776-1191  
[www.txchange.com](http://www.txchange.com)

# Heavy Duty Suspension Specialists



Parts • Manufacturing • Service  
**TRUCK • TRAILER • RV • CLASSIC**

**Oregon Auto Spring Service Inc.**  
**503-234-9611**  
**800-423-6976**

18650 SW Pacific Hwy Tualatin, OR 97062  
Email: [Sales@OregonAutoSpring.com](mailto:Sales@OregonAutoSpring.com)  
[www.OregonAutoSpring.com](http://www.OregonAutoSpring.com)



**Roland Havens Insurance Agency Inc**  
Roland Havens, Agent

6720 NE Glisan Street  
Portland, OR 97213-5554  
Bus 503 252 1608 Fax 503 252 1607  
[roland.havens.b7zr@statefarm.com](mailto:roland.havens.b7zr@statefarm.com)

*Good Neighbor Agent since 1982*

**PMX Custom Alternators and Starters**  
Top Quality Custom rebuilding since 1977

**Bill Jungck**  
Owner

8420 SE Hinckley Ave.  
Happy Valley, Or. 97086  
[www.pmxalternators.com](http://www.pmxalternators.com)

503-777-7172  
[pmxbill@comcast.net](mailto:pmxbill@comcast.net)



Foreign & Domestic • Tune-Ups • Timing Belts  
Shocks • CV Shafts • Custom 3" Exhausts

**Craig Sieckmann**  
503-236-4913

4542 SE 26th Ave  
Portland, OR 97202





# The World's Largest Inventory of Studebaker Upholstery!

All Years and Models

Cloth • Vinyl • Wool • Headliners • Carpets  
Door Panels • Windlace • Trunk Lining

## SMS AUTO FABRICS

SMSAutoFabrics.com • 503-263-3535

### ADVERTISERS' INDEX

Throughout this booklet, you'll find advertisements for businesses in the Grand Ronde area and elsewhere in Northwest Oregon. We encourage you to visit these businesses whenever

you're looking for a place to purchase food, fuel, parts, services and other needs while you are attending the 2022 Pacific Can-Am Zone Meet. They support us and they deserve your support.

ADVERTISER	PAGE NUMBER	ADVERTISER	PAGE NUMBER
Golden Hawk 56J Parts, Brent Hagen	7	RAG Auto Repair	17
Golden Hawk Firearms Training	7	Refinishing Touch Auto Body	13
Hayes Auto Upholstery	13	Roland Havens State Farm Insurance	17
Industrial Tire Service	13	Ron's Front End & Brake	11
Northwest Battery Supply	11	SMS Upholstery	18
Oregon Auto Spring	17	Studebaker Center of Oregon	15
PMX Alternators	17	The Insurance Garage	7
		Transmission Exchange Co.	17



REGISTRATION

Mail the completed form with a check payable to "Northwest Chapter, SDC" to: Tom Hart, 3417 W 8th St., The Dalles, OR 97058-4435

Attendees

Last Name: \_\_\_\_\_ First Name: \_\_\_\_\_

Spouse/Guest(s): \_\_\_\_\_ Children (ages): \_\_\_\_\_

Mailing Address

Street/PO Box: \_\_\_\_\_

City: \_\_\_\_\_ State/Province: \_\_\_\_\_ Zip/Postal Code: \_\_\_\_\_

Phone: \_\_\_\_\_ Email: \_\_\_\_\_

Membership(s): \_\_\_\_\_ member # Intl. SDC \_\_\_\_ ASC \_\_\_\_ AOAI \_\_\_\_ Packard club. SDC Ch.: \_\_\_\_\_

Registration Fees and Charges

- General Registration Fee (includes members of immediate family)
  - If paid by Aug. 1, 2022 (early bird discount) ..... \$40 \$ \_\_\_\_\_
  - If paid after Aug. 1, 2022 ..... \$50 \$ \_\_\_\_\_
- Friday evening social at Spirit Mountain Lodge (cash bar) 6:00-10:00pm ..... (per person) \_\_\_\_\_ x \$15 \$ \_\_\_\_\_
- Display Fee, per car entered in People’s Choice Judging ..... \_\_\_\_\_ x \$10 \$ \_\_\_\_\_
 

Car Year, Make, Model \_\_\_\_\_

(If entering more than 1 car, write year, make, & model for additional cars on back of form)
- Swap Meet Fee ..... (per 10’ x 20’ space) \_\_\_\_\_ x \$25 \$ \_\_\_\_\_
- Saturday Awards Banquet Dinner. Tour of Italy buffet, inc. dessert, coffee/tea, tax, and 17% gratuity. (Cash bar)
 

Total Dinner Banquet Meals \_\_\_\_\_ x \$39 \$ \_\_\_\_\_
- Sunday Cruise from Spirit Mountain to Garibaldi and Train Ride from Garibaldi to Rockaway Beach
 

Train Ride ..... (per person) \_\_\_\_\_ x \$20 \$ \_\_\_\_\_
- Zone Meet T-shirts. Available in S, M, L, & XL for \$18 Available in 2XL or 3XL for \$20
 

List size(s) and quantity: \_\_\_\_\_ \$ \_\_\_\_\_

TOTAL DUE: \$ \_\_\_\_\_

Zone Meet Headquarters: Spirit Mountain Casino Lodge, 27100 Salmon River Hwy, Grand Ronde, OR 97347

Hotel Reservations: \$149 per room, plus 10% tax. Spirit Mountain Casino. By Phone: 1-800-760-7977 & give booking ID 3019 (Studebaker of Oregon). Online: Go to Spirit Mountain Casino’s website and click “Group Sign In” at top, enter Group Code: 3019.

Information/Questions: See website at sdc-nw.org or contact Tom Hart at (541) 490-6272 or [roadio55@hotmail.com](mailto:roadio55@hotmail.com)

DRIVERS CLUB  
2022 PACIFIC CAN-AM ZONE MEET

Studebaker

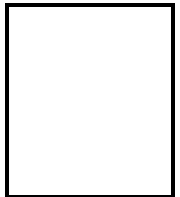

SDC Northwest Chapter  
Jennifer Arnold, Editor  
140 Ray Road  
Toledo, WA 98591

